



Fairway Close

Harpenden, AL5 2NN

Completed in 2018 by the highly reputable Tilsworth Developments, this fabulous six bedroom family home offers 5,250 sq ft of immaculately presented living and entertaining space, together with a south facing garden. Fairway Close is a peaceful cul de sac, in the heart of the popular West Common Area.

Guide price £3,000,000

Fairway Close

Harpenden, AL5 2NN



6



5



4



B

- Completed in 2018
- Arranged over three floors
- Five Bathrooms
- Built by Tilsworth Developments
- Fabulous Open Plan Kitchen / Dining / Family Room
- South facing Garden
- Circa 5,250 sq ft
- Six Bedrooms
- Integral Garage

Entrance Hall

Lounge

20'8" x 19'4" (6.32 x 5.90)

Family Room

26'4" (max) x 20'10" (8.04 (max) x 20'0" x 17'8" (6.12 x 5.40) 6.36)

Dining Room

17'8" x 17'4" (5.40 x 5.30)

Kitchen

26'0" x 15'4" (7.93 x 4.68)

Children's Room

17'7" x 15'4" (5.36 x 4.68)

Study

13'1" x 8'6" (4.00 x 2.60)

Utility Room

15'4" x 5'6" (4.68 x 1.68)

Cloakroom

Bedroom One

Dressing Room

13'3" x 9'1" (4.05 x 2.79)

En-suite Shower Room

Bedroom Two

19'4" x 17'9" (max) (5.90 x 5.43 (max))

En-suite Shower Room

Bedroom Three

15'1" x 13'3" (4.62 x 4.05)

En-suite Shower Room

Bedroom Four

13'1" x 11'3" (4.00 x 3.43)

Bedroom Five

13'1" x 11'0" (4.00 x 3.37)

Bedroom Six

21'9" (max) x 13'0" (6.65 (max) x 3.97)

En-suite Shower Room

Integral Garage

17'8" x 13'1" (5.40 x 4.00)





Floor Plan

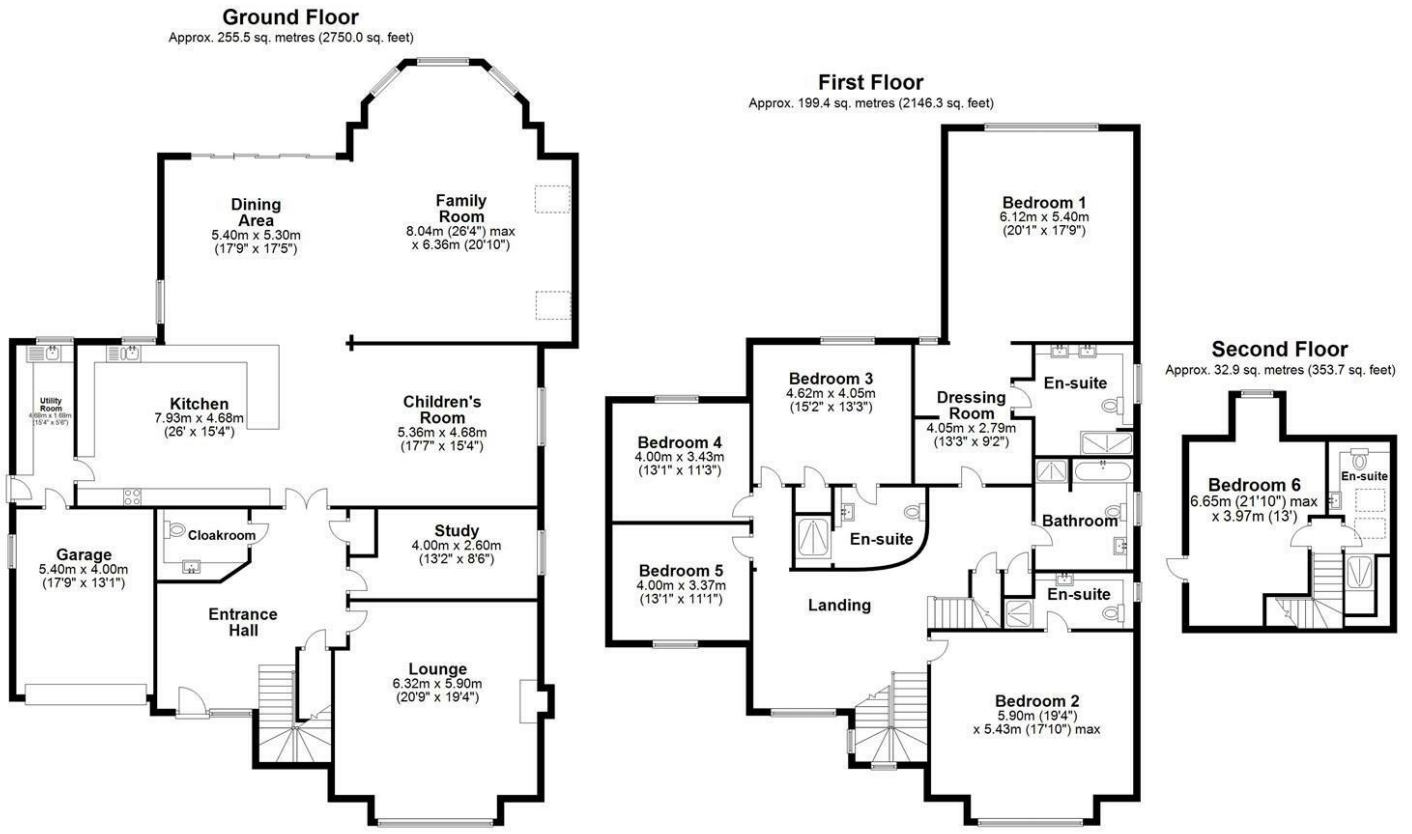

Total area: approx. 487.7 sq. metres (5250.0 sq. feet)
Sketch layout only. Not to scale. Plan produced for Whittaker & Co.

Plan produced using PlanUp.

These particulars, whilst believed to be accurate are set out as a general outline only for guidance and do not constitute any part of an offer or contract. Intending purchasers should not rely on them as statements of representation of fact, but must satisfy themselves by inspection or otherwise as to their accuracy. No person in this firm's employment has the authority to make or give any representation or warranty in respect of the property.

